

# 1700 Series D1703

13 kWm / 17.3 hp @ 1500 rpm

Page 1

The Kyopower D1703 engine family continues to set new standards in the compact engine market. Developed alongside customers to fulfill their needs in the generator set, compressor, agricultural and general industrial markets.

These new Model provide compact power, from a robust family of 4 cylinder diesel engines designed to provide economic and durable operation at prime and standby duties, hitting the key power nodes required by the power generation industry.

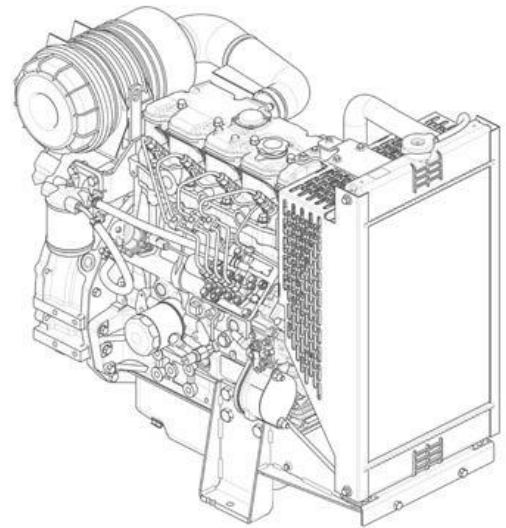

Specification	
Model	D1703
Type	Vertical, water cooled 4-cycle diesel engine
Number of cylinders	4, in-line
Bore and stroke	85 x 100 mm
Displacement	2.27 litres
Firing order	1-3-4-2
Aspiration	Naturally aspirated
Cycle	4 stroke
Combustion system	Indirect injection
Compression ratio	19.0:1
Rotation	Anti-clockwise, viewed on flywheel
Cooling system	Water cooled
Type of fuel	Diesel fuel only (JPN:JIS-NO.2, US:ASTM-2D, EU:EN590)
Starting method	Electric
Fuel consumption (g/kWh)	≤ 240

Photographs are for illustrative purposes only and may not reflect final specification.  
All information in this document is substantially correct at time of printing and may be altered subsequently.  
Final weight and dimensions will depend on completed specification

**KYO**POWER

**Thien Hoa An**  
Địa chỉ: 194 Trường Chinh | quận Đống Đa | Hà Nội  
Tel: (024)73033333 | Fax: (024) 3563 6739 | Email: tha@thienhoan.com | <https://thienhoan.com>

# 1700 Series D1703

13 kWm / 17.3 hp @ 1500 rpm

Page 2

## Features and benefits

### Powered by your needs

- The D1703 is a powerful but quiet naturally aspirated 4-cylinder compact package

### Compact, clean, efficient power

- Design features on the D1703 range of ensures clean rapid starting in all conditions whilst delivering impressive performance with low operating costs in a small, efficient package size

### Lower operating costs

- Approved for operation on biodiesel\* concentrations of up to 20%
- Oil and filter changes are 500 hours, dependent on load factor
- Engine durability and reliability, the warranty offering and ease of installation combine to drive down the cost of ownership
- Warranties and Service Contracts

We provide one-year warranties for constant speed engines and two-year warranties for variable speed models, as standard. These are supported by multilevel Extended Service Contracts that can be bought additionally

Discover more: [www.thienhoaan.com](http://www.thienhoaan.com)

## Product support

- With highly trained Thien Hoa An distributors in thousands of communities in over 50 authorized dealer, you are never far away from expert product knowledge, genuine parts and a range of advanced diagnostic technology for keeping your engine in peak condition.

\*Subject to conformance with ASTM D6751 and EN14214

Photographs are for illustrative purposes only and may not reflect final specification.  
All information in this document is substantially correct at time of printing and may be altered subsequently.  
Final weight and dimensions will depend on completed specification

**KYO**POWER

#### Thien Hoa An

Địa chỉ: 194 Trường Chinh | quận Đống Đa | Hà Nội  
Tel: (024)73033333 | Fax: (024) 3563 6739 | Email: [tha@thienhoaan.com](mailto:tha@thienhoaan.com) | <https://thienhoaan.com>

# 1700 Series D1703

13 kWm / 17.3 hp @ 1500 rpm

Page 3

Speed rpm	Type of operation	Typical generator output (Net)		Engine power	
		kVA	kWe	kW	hp
1500	Prime power	14,2	11,3	13,0	17,3
	Standby power	16,3	13,0	15,0	20,0

The above ratings represent the engine performance capabilities to conditions specified in ISO 8528/1, ISO 3046/1:1986, BS 5514/1. Derating may be required for conditions outside these; consult Thien Hoa An Co.,Ltd

Generator powers are typical and are based on typical alternator efficiencies and a power factor ( $\cos \varphi$ ) of 0.8. Fuel specification: BS 2869: Part 2 1998 Class A2 or ASTM D975 D2.

Rating definitions: Prime power: Power available at variable load in lieu of a main power network. Overload of 10% is permitted for 1 hour in every 06 hours operation. Standby (maximum): Power available at variable load in the event of a main power network failure. No overload is permitted.

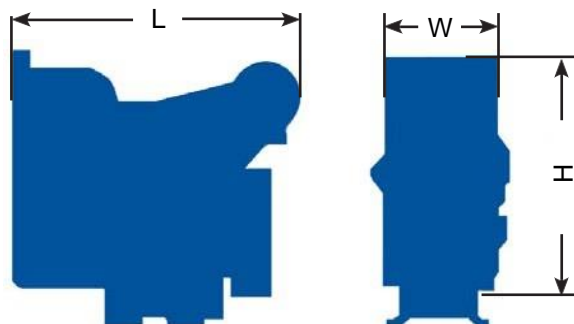

Engine dimensions	
Length (L)	750 mm
Width (W)	550 mm
Height (H)	680 mm
Weight (dry)	240 kg

Photographs are for illustrative purposes only and may not reflect final specification.  
All information in this document is substantially correct at time of printing and may be altered subsequently.  
Final weight and dimensions will depend on completed specification

**KYO**POWER

**Thien Hoa An**  
Địa chỉ: 194 Trường Chinh | quận Đống Đa | Hà Nội  
Tel: (024)73033333 | Fax: (024) 3563 6739 | Email: tha@thienhoan.com | https://thienhoan.com

# 1700 Series D1703

13 kWm / 17.3 hp @ 1500 rpm

Page 4

## Technical information

Air inlet	
Air Cleaner Type	Dry Type
Air filter	Air filter, Replaceable

Fuel system	
Fuel system	Mechanical
- Governor	All speed, mechanical centrifugal
- Speed regulation rate in steady state	$\leq 5\%$
- Fuel filter	Primary fuel filter (to separate water), secondary fuel filter, Replaceable

Lubricating system	
Lubricating system	Forced circulation by trochoid gear pump
Lubricating oil capacity (with filter) (L)	7,8
Lubricating oil consumption (L/h)	0.05
Oil filter	Oil filter, Replaceable
Oil dipstick	Standard dipstick
Oil pressure switch	Yes
Oil pressure unit	Yes

Cooling system	
Cooling system	Water coolant closed circuit with radiator, expansion tank
Water capacity	NA
Water pump flow rate-lift(L/s-mH2o)	2257rpm 60- $\geq 4.5$ m
Water temp. switch	Yes
Thermo. Unit	Yes
Water temperature sensor parameter	97°C $\pm 2^\circ\text{C}$

Photographs are for illustrative purposes only and may not reflect final specification.  
All information in this document is substantially correct at time of printing and may be altered subsequently.  
Final weight and dimensions will depend on completed specification

**KYO**POWER

Thien Hoa An  
Địa chỉ: 194 Trường Chinh | quận Đống Đa | Hà Nội  
Tel: (024)73033333 | Fax: (024) 3563 6739 | Email: tha@thienhoan.com | <https://thienhoan.com>

# 1700 Series D1703

13 kWm / 17.3 hp @ 1500 rpm

Page 5

Electrical system	
Alternator	14V - 0.5kW
Starting system	Electric starting
Starter motor	12V - 3.5kW
Glow plug	Glow plug cold start aid and heater/starter switch
Battery Volts	12V
Battery Capacity	≥ 60Ah

Temperature and pressure limit	
Exhaust temperature after turbine (°C )	500

## Optional equipment

- Parts book

## Option groups

- A selection of optional items is available to enable you to prepare a specification precisely matched to your needs.

Photographs are for illustrative purposes only and may not reflect final specification.  
All information in this document is substantially correct at time of printing and may be altered subsequently.  
Final weight and dimensions will depend on completed specification

**Thien Hoa An**  
Địa chỉ: 194 Trường Chinh | quận Đống Đa | Hà Nội  
Tel: (024)73033333 | Fax: (024) 3563 6739 | Email: tha@thienhoan.com | <https://thienhoan.com>

**KYO**POWER